

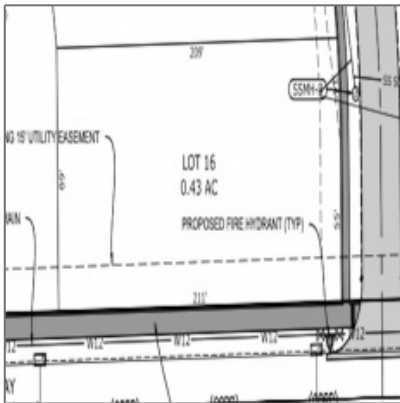

Lots/land For Sale

0 Sqft - Lot 16 Kona Cir, Coralville, Iowa 52241



Description

Exceptional and highly desired single family home lot located on the West side of Iowa City and Coralville off Camp Cardinal Blvd. Large lot perfect for building your own home! *This lot is not for individual sale but rather will be included in a “Custom Built Home Package” with Navigate Homes. The lot is being marketed so that potential Buyers are aware of additional options for construction.*

Property Description

Exceptional and highly desired single family home lot located on the West side of Iowa City and Coralville off Camp Cardinal Blvd. Large lot perfect for building your own home! *This lot is not for individual sale but rather will be included in a “Custom Built Home Package” with Navigate Homes. The lot is being marketed so that potential Buyers are aware of additional options for construction.*

Basic Details

Property Type:	Lots/land
Listing Type:	For Sale
Listing ID:	202203331
Price:	\$135,000
Beds:	0

Baths:	0
Half Bathrooms:	0
Square Feet:	0 Sqft
Construction Year:	0
Lot Size:	0.43 Sqft
Country:	US
State:	IA
County:	Johnson
City:	Coralville
Zipcode:	52241
Status Category:	Active
Area:	Coralville
Subdivision:	Cardinal Pointe West

Features

✓	Amenities:	Street Lights, Close To School, Underground
Internet:		Yes
✓	Possible Finance:	Cash, Conventional
✓	Showing Instructions:	Under Construction

Address [Map](#)

Street:	Lot 16 Kona Cir
Floor Number:	0
Longitude:	W92° 23' 27.1"
Latitude:	N41° 40' 14.2"

More [Information](#)

Office Name:	Urban Acres Real Estate Corridor
Sales Term:	Conventional
Update Date:	08-23-2022 19:15:23
Elementary School:	Borlaug

Jr./Middle School:	Northwest
High School:	West
Directions:	Camp Cardinal Blvd, West on Kennedy Parkway, Right on to Kona Cir
Zoning:	Residential
Lot Dimensions:	Regular
LA1Agent Logon Name:	I628
LA1Agent First Name:	Mike
LA1Agent Last Name:	Bails
LO1Main Office ID:	429
PriceChangeTimestamp:	06-04-2022

Agent Information



- **Mike Bails**
- 319.321.5500
- mikebails@urbanacres.com

Additional Details

Amenities: Street Lights, Close To School, Underground
Possible Finance: Cash, Conventional
Showing Instructions: Under Construction
Listing Date: 06/04/2022
Directions: Camp Cardinal Blvd, West On Kennedy Parkway, Right On To Kona Cir
Lot Dimensions: Regular
